

Stainless Steel Care Guide

Stainless Steel is a durable product, however it requires some care to keep it looking it's best.

- After use, your Stainless steel sinkware should be wiped down using a soft, damp, soapy cloth (alternatively Windex or similar) rinsed off and then dried. Please take note that "Hard water" can cause a buildup of a "greyish" film on the steel causing a discoloration.
- Wire wool and abrasive cleaners should be avoided. Steel wool tends to leave minute particles of wire on the surface of the sinkware, which quickly develops into rust marks. Always remove damp sponges, brushes and cloths from the sink to avoid water marks.
- Do not expose the sinkware to bleaches containing Hypochloride (Janola for example) for extended periods as this can cause "pitting" in the surface of the stainless steel. Also, a reminder that abrasive cleaners, chemicals used to unblock drains, silver dip cleaner, salt and vinegar should be diluted as quickly as possible and flushed away.



Soft Cloth



Rinse



Polish

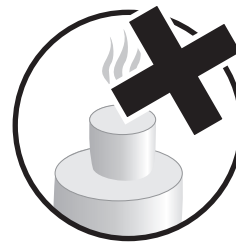

Harsh Chemicals



Abrasives



Guide for the TopMount installation of Mercer NZ manufactured sinkware.

The following steps are intended to assist you with the installation of Mercer sinkware, the advised methods are provided in good faith, and are believed by Mercer to provide satisfactory results. However, any advice, information or assistance is provided as a guide only, and given by Mercer without responsibility or liability.

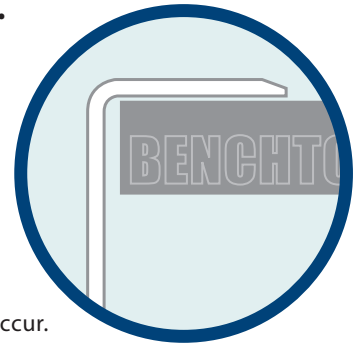

Some of the things you'll need:

The following items will make installing easier, but before you even pick one up:

- Check the sink is the correct model you require, and in good condition
- Make sure you handle the product carefully, some sinks may have sharp edges and injuries can occur.

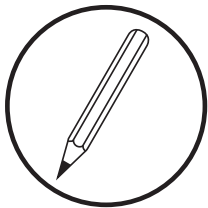

Pencil/Marker

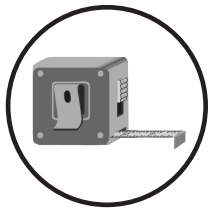

Tape Measure



Sealant



Screwdriver



Cutting Device



Safety Gear

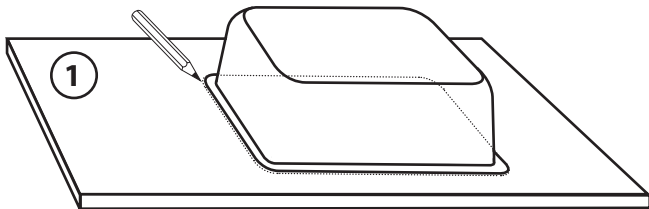

- 1) Place the bowl upside down on the bench in the exact location required. Carefully mark the outline of the bowl using a pencil or a white coloured water-based paint pen (for darker coloured bench top surfaces).

REMEMBER: Measure twice, cut once.

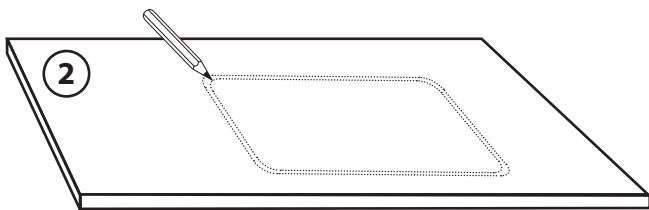

- 2) Accurately mark out a second line 10mm inside the initial bowl outline (to the appropriate measurement, there are many differences in flange dimensions); this will be the actual cut-out line. Next, proceed to create the cut-out using tooling suited to the bench top material (jig-saw or router etc).

CAUTION: Cut exactly to the inside cut-out line, and no closer to the actual outline of the physical sink.

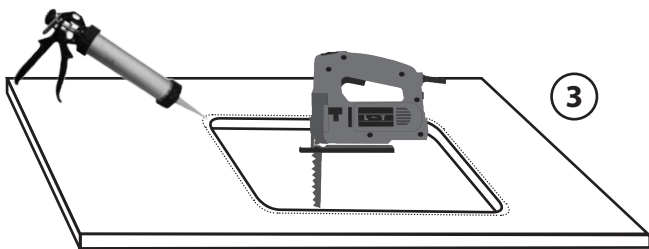

- 3) Waterproof and seal the exposed substrate. Clean the edge where the sink flange will sit with white spirits and a cloth to remove any grease or oily residue. Now apply a generous bead of silicone sealer to the top facing edge of the cut-out.

NOTE: Ensure to use a suitable silicone for bonding Metal/Stainless-Steel to the selected bench top material.

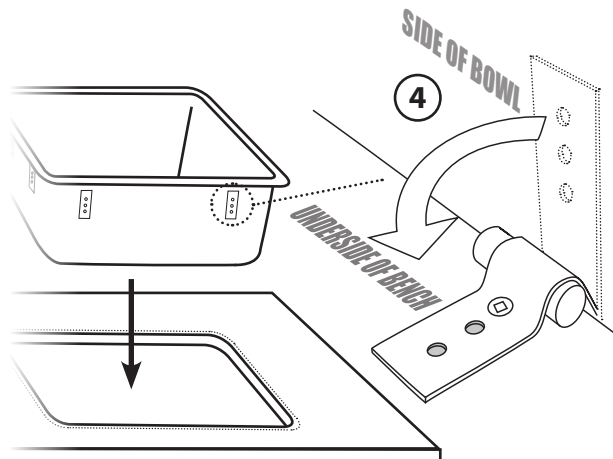

- 4) On the underside of the cut-out, hold a small piece of doweling (or similar) in front of each fixing strap and fold around. Insert a screw into the closest hole to the doweling, and carefully tighten (preferably by hand) until the flange pulls down flat

NOTE: Do not over tighten the screws.

- 5) Remove any excess silicone, then wipe clean and smooth with white spirits and a clean cloth.

TIP: Before cleaning, spray the entire area with a basic "Spray & Wipe" household cleaner, then use a plastic scraper or laminate strip to remove the excess silicone. This will stop the sealer from smearing over a wider area and speed up the cleaning time.